

**WARNING** PLEASE FOLLOW ASSEMBLY INSTRUCTIONS. DO NOT USE SHELVES OR CONNECTORS WITH COMPONENTS OTHER THAN E-Z-RECT PRODUCTS.

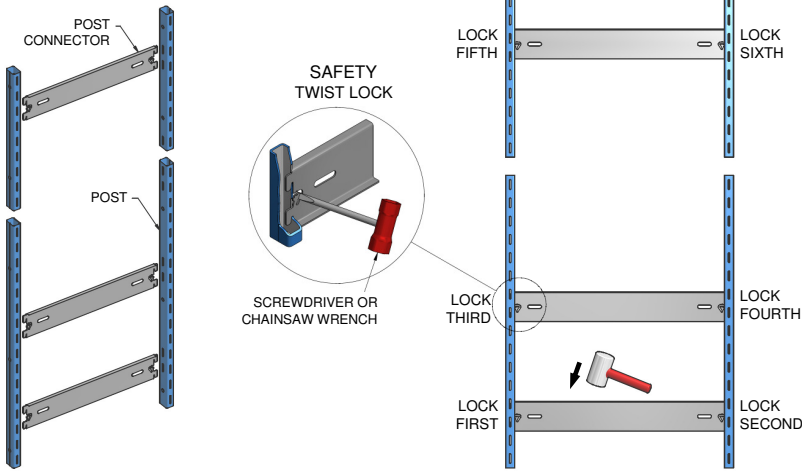

**STEP ONE**

**FRAME ASSEMBLY**

**STEP TWO**

Place post flat on the ground so that Post Connector slots are on the inside and the seam is on the outside. Post Connector slots are adjustable every 12" (305mm). Arrange Post Connectors at desired location, normally evenly spaced, with one always at top and bottom of post.

Starting from the bottom tap in one side of the Post Connector and LOCK IMMEDIATELY. Then tap in and lock the other side. The post will have to be spread lightly as you work your way up the post. Use a 1/4" or a 3/8" screwdriver or chainsaw wrench to lock connectors. Assembly time is approximately 1 to 2 minutes per 84" (2134mm) frame.

**CAUTION POST CONNECTOR MUST BE LOCKED FOR SAFETY**

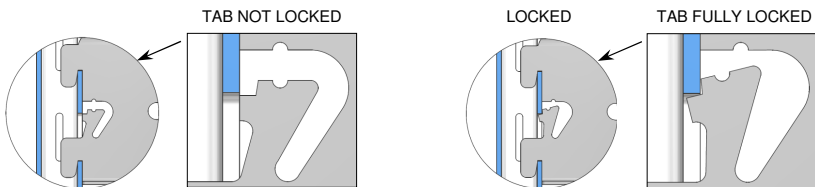

**LOAD CAPACITIES (IN LBS.)** Maximum evenly distributed static load per pair of connectors

SHELF LENGTH	36"	42"	48"	60"	66"	72"	96"
PB Frame Connectors	400	340	300	150	-	-	-
B Frame Connectors	700	620	550	400	-	-	-
with L Tie & O Shelf Support	1400	1100	900	530	-	-	-
WB Frame Connectors	1200	1050	950	700	575	480	-
with WT Combination Tie Bar & Shelf Support	1800	1640	1500	1200	1030	900	-
HD Frame Connectors	1650	1550	1400	1000	900	800	450
with WT Combination Tie Bar & Shelf Support	2000	1950	1900	1700	1600	1500	900*
XHD Frame Connectors	-	-	-	-	-	-	-
with WT Combination Tie Bar & Shelf Support	-	-	2400	2400	2400	2400	1700*

Connectors are designed for an overall Safety Factors of 1.66 to 1 which conforms to AISI Standards. Deflection is limited to 1/140 for spans.  
 \* Two WT Combination Tie Bar and Shelf Supports must be used.

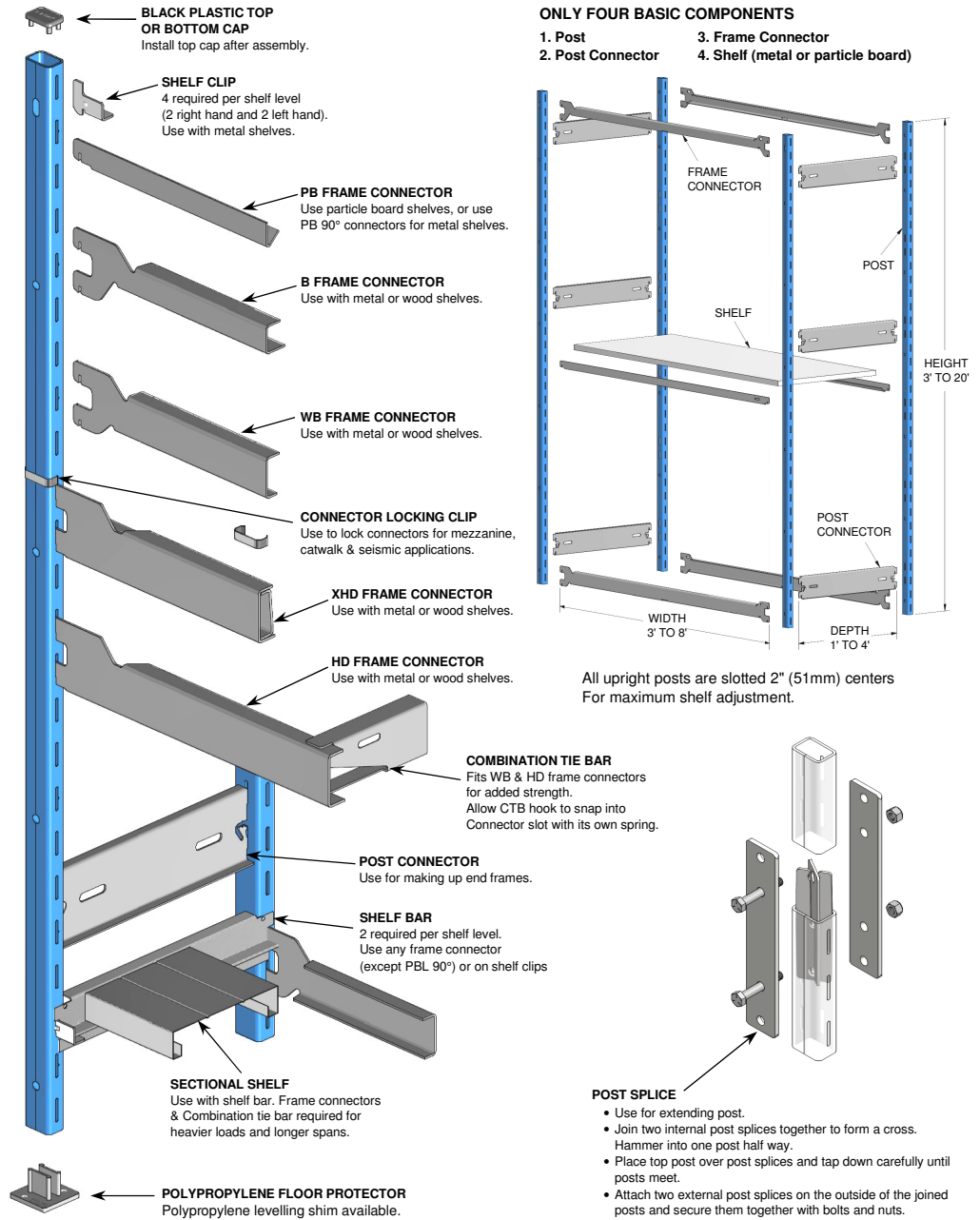

**ONLY FOUR BASIC COMPONENTS**  
 1. Post  
 2. Post Connector  
 3. Frame Connector  
 4. Shelf (metal or particle board)

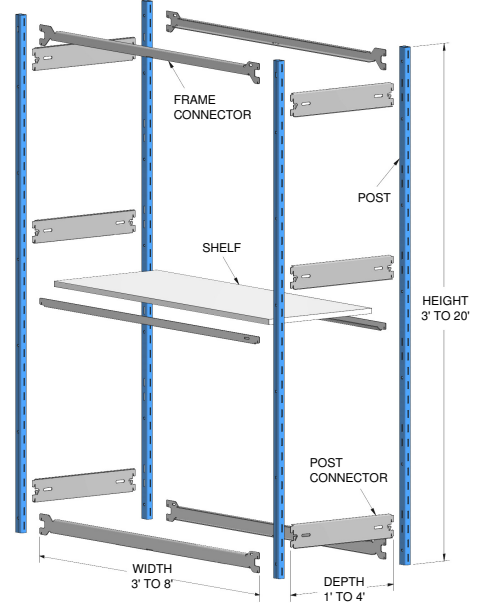

All upright posts are slotted 2" (51mm) centers For maximum shelf adjustment.

- POST SPLICE**
- Use for extending post.
  - Join two internal post splices together to form a cross. Hammer into one post half way.
  - Place top post over post splices and tap down carefully until posts meet.
  - Attach two external post splices on the outside of the joined posts and secure them together with bolts and nuts.



**e-z-rect TYPE 1**

**E-Z-RECT MANUFACTURING LTD.**

Head Office: North Vancouver, P: 604 929 5461 Email: sales@ezrect.ca Web: www.ezrect.ca  
 Eastern Sales: Mississauga, P: 905 564 0890 Email: torontosales@ezrect.ca Web: www.ezrect.ca  
 UK Sales: Oxon, P: 01993 779494 Email: mail@ezrshelving.com Web: www.ezrshelving.com

**FRAME CONNECTOR ASSEMBLY**

1. Insert frame connector hooks all the way into post as shown below in order to allow for the opposite side to enter and line up at the same slot level.
  2. Tap down with rubber mallet to finish.
- Note:** Each level can be easily changed without dismantling the unit.

**WARNING ALLOWABLE SPACING BETWEEN CONNECTORS**

See Below	Light Loads Up to 3,000lb (1,363kg)	Medium Loads Up to 6,000lb (2,726kg)	Heavy Loads Up to 9,000lb (4,089kg)
Dimension A Not to Exceed	28"	20"	12"
Dimension B Not to Exceed	36"	54"	36"

**NUMBER OF POST CONNECTORS REQUIRED**

WARNING		Height of Post	Light to Medium Loads up to 6,000lb (2,727kg) or up to 30" (762mm) in Depth
Inches	Metric		
36"	914mm		2
48" to 84"	1219mm to 2314mm		3
96" to 120"	2438mm to 3048mm		4
132" to 168"	3353mm to 4267mm		5
180" to 192"	4572mm to 4877mm		7

**CAUTION LAY THE SHELF ON TOP OF FRAME CONNECTOR**

**NUMBER OF POST CONNECTORS REQUIRED**

WARNING		Height of Post	Heavy Loads over 6,000lb (2,727kg) to 10,000 (4,545kg) or 36" (914mm) and over in Depth
Inches	Metric		
36"	914mm		3
48" to 84"	1219mm to 2314mm		4
96" to 120"	2438mm to 3048mm		5
132" to 168"	3353mm to 4267mm		6
180" to 192"	4572mm to 4877mm		8

**NOTICE LAYOUT INFORMATION AND CREEPAGE**

When designing shelving layout, allow for an additional 1 1/2" (38.1 mm) creepage for each end frame in the row and 1" (25.4 mm) creepage in depth for each end frame.

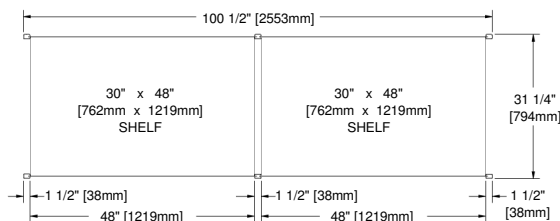

**IMPORTANT NOTES:**

- Post Connector requirements are for static loading only; no shocks, vibrations, seismic mobile or other conditions are considered.
- Always lock all post connectors on both sides to the posts that make up the shelving end frame. Refer to the assembly instructions guide for typical placement.
- Be sure the post connectors are tapped down completely so the locking tab can be fully engaged before twisting the locking tab as per drawing. It is the best to use a chainsaw wrench but a 3/8" screwdriver can be used.
- Not locking the post connectors can lead to a dangerous situation and the shelving could collapse.
- Please contact your sales representative or the factory direct for help on design, seismic and mobile aisle, CDN./ U.S. 1 888 397 4353 • U.K. 01993 779494.